

R&D MARINE

Engine Mounts

Designed for any type of engine

- 2 & 3 cylinder long stroke.
- 1, 2 & 3 cylinder short stroke.
- High speed 4 cylinder, 6 cylinder and more.

Wide range in stock

Standard sizes offer different weight capacity, footprint, stud size and height. This enables direct plug-in replacement for most installations. Capacity from 30 - 2,000 lbs. per mount.

Fail safe design

The vertical stud is secured to a horizontal metal plate, to prevent the mount from pulling apart. R&D Engine Mounts will withstand a roll over test.

Fast installation time

Slotted holes and height adjustment to simplify alignment.

Good vibration isolation

Shear loaded mounts provide superior isolation and restrict fore and aft movement to maintain alignment. Compression mounts are available where there is a restriction on the available space.



(800) 523-7558

www.pyiinc.com

Compression Mountings

R & D MARINE COMPRESSION MOUNTING

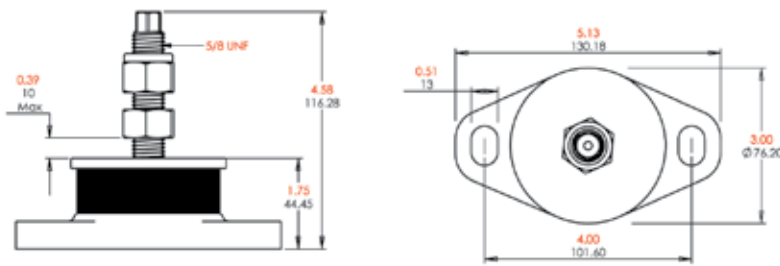

This is a low height mounting with minimum deflection

5/8" Stud		
Part No	Capacity per mount	
	kg	lbs
800-003	45-82	100-180
800-004	73-168	160-370
800-005	145-227	320-500
Mount Pre-loaded	1.5mm	0.06 inch
Deflection	2.3mm	0.09 inch
Height adjusting nut thickness	14mm	0.55 inch

R & D MARINE COMPRESSION MOUNTING

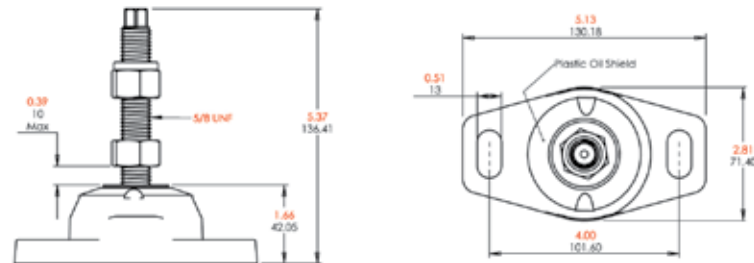

This mounting is a competitive, low height medium capacity mount giving good engine control

5/8" Stud		
Part No	Capacity per mount	
	kg	lbs
800-033	86	190
800-036	136	300
Deflection	1.65mm	0.065 inch
Height adjusting nut thickness	14mm	0.55 inch

Rectangular Shear Mountings

The R & D Rectangular Shear Mountings offer low height with the best combination of stiffness. Soft vertically and at right angles to the crankshaft to isolate vibration, stiff fore and aft to take the propeller thrust.

R & D MARINE SMALL SHEAR LOADED MOUNTING

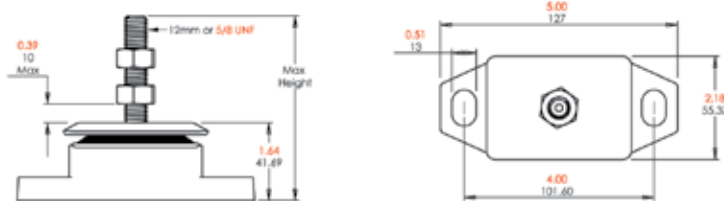

This mounting has a low height giving good vibration isolation

12mm Stud			5/8" Stud		
Part No	Capacity per mount		Part No	Capacity per mount	
	kg	lbs		kg	lbs
800-038	14-41	30-90	800-040	14-42	30-91
800-039	32-77	70-170	800-041	32-78	70-171
Mount Pre-loaded	1.8mm	0.07 inch			
Deflection	1.8-3.4mm	0.07-0.14 inch			
Height adjusting nut thickness :	10mm	0.39 inch	14mm	0.55 inch	
Maximum height:	99mm	3.9 inch	116mm	4.57 inch	

R & D MARINE SHEAR LOADED "SUPER MOUNTS"

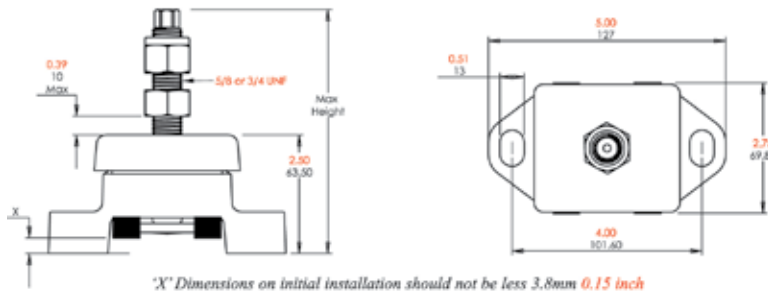

'X' Dimensions on initial installation should not be less 3.8mm 0.15 inch

Fitted with an oil shield to protect the rubber

5/8" Stud			3/4" Stud		
Part No	Capacity per mount		Part No	Capacity per mount	
	kg	lbs		kg	lbs
800-037	23-80	50-175	800-020	36-106	80-231
800-010	36-105	80-230	800-021	55-187	120-411
800-011	55-186	120-410	800-022	114-256	250-561
800-012	114-255	250-560	800-023	136-310	300-681
800-014	136-309	300-680			
Mount Pre-loaded	2.3mm	0.09 inch			
Deflection	2.3-5.4mm	0.09-0.21 inch			
Height adjusting nut thickness :	14mm	0.55 inch	11mm	0.43 inch	
Maximum height:	137mm	5.38 inch	165mm	6.5 inch	

R & D MARINE SHEAR LOADED "SUPER MOUNTS"

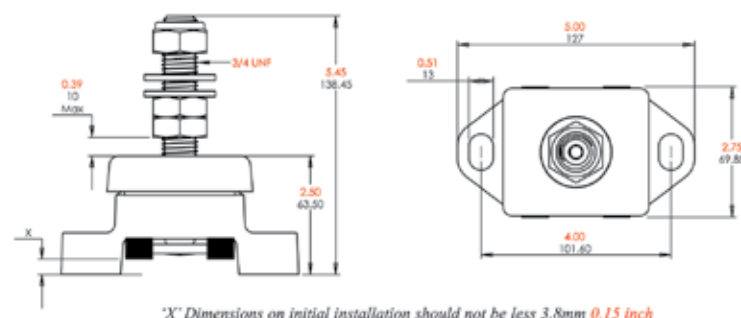

'X' Dimensions on initial installation should not be less 3.8mm 0.15 inch

Fitted with an oil shield to protect the rubber

3/4" Stud		
Part No	Capacity per mount	
	kg	lbs
800-051	36-108	80-235
800-052	55-187	120-415
800-053	114-257	250-565
800-054	136-311	300-685
Mount Pre-loaded	2.3mm	0.09 inch
Deflection	2.3-5.4mm	0.09-0.21 inch
Height adjusting double nut and washer thickness	25mm	0.97 inch

Units of measurement: Black Millimetres Red Inches

Rectangular Shear Mountings

R & D MARINE SHEAR LOADED "SUPER MOUNTS"

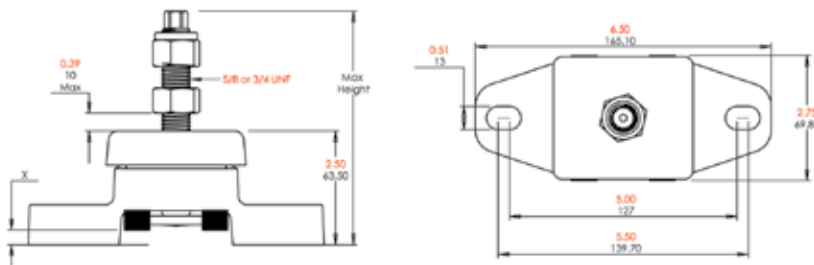

"X" Dimensions on initial installation should not be less 3.8mm 0.15 inch

Fitted with an oil shield to protect the rubber

5/8" Stud			3/4" Stud		
Part No	Capacity per mount		Part No	Capacity per mount	
	kg	lbs		kg	lbs
800-062	23-81	50-176			
800-024	36-106	80-232	800-028	36-107	80-233
800-025	55-187	120-412	800-029	55-188	120-413
800-026	114-256	250-562	800-030	114-257	250-563
800-027	136-310	300-682	800-031	136-311	300-683

Mount Pre-loaded 2.3mm 0.09 inch

Deflection 2.3-5.4mm 0.09-0.21 inch

Height adjusting

nut thickness: 14mm 0.55 inch | 11mm 0.43 inch

Maximum height: 137mm 5.38 inch | 165mm 6.5 inch

R & D MARINE SHEAR LOADED "SUPER MOUNTS"

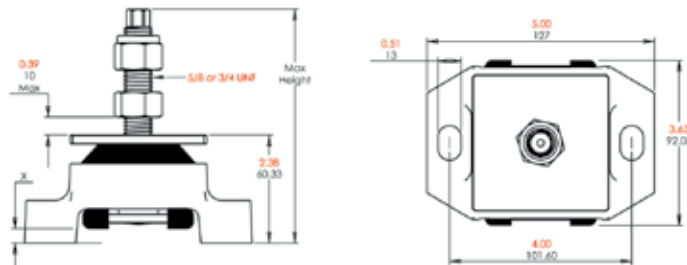

"X" Dimensions on initial installation should not be less 3.8mm 0.15 inch

Fitted with an oil shield to protect the rubber

5/8" Stud			3/4" Stud		
Part No	Capacity per mount		Part No	Capacity per mount	
	kg	lbs		kg	lbs
800-013	155-345	340-760	800-035	155-346	340-761

Mount Pre-loaded 2.3mm 0.09 inch
Deflection 2.3-4.8mm 0.09-0.19 inch
Height adjusting
nut thickness: 14mm 0.55 inch | 11mm 0.43 inch
Maximum height: 137mm 5.38 inch | 152mm 6.0 inch

R & D MARINE SHEAR LOADED HIGH CAPACITY "SUPER MOUNT"

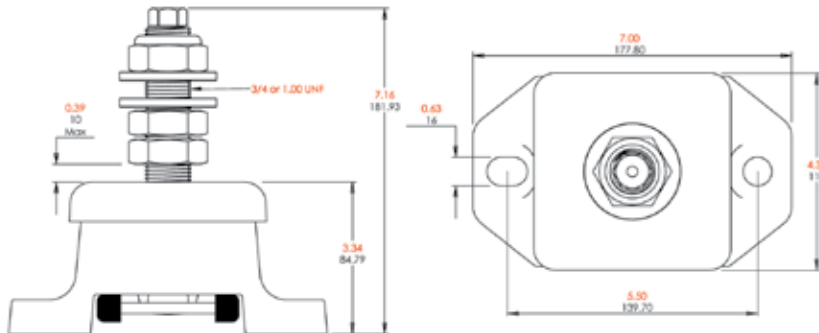

Fitted with an oil shield to protect the rubber

3/4" Stud			1" Stud		
Part No	Capacity per mount		Part No	Capacity per mount	
	kg	lbs		kg	lbs
800-063	227-590	500-1300	800-066	227-591	500-1301
800-064	295-772	650-1700	800-067	295-773	650-1701
800-065	500-954	1100-2100	800-068	500-955	1100-2101

Mount Pre-loaded 3mm 0.12 inch
Deflection 3-6.4mm 0.12-0.25 inch
Height adjusting double nut & washer thickness (1" UNF Stud): 31.75mm 1.25"
Height adjusting nut thickness (3/4" Stud): 16mm 0.63"

Note:
3/4" UNF Engine Mounts
Supplied With Only
1 off Height Adjusting Nut
And No Washers

Circular Shear Mountings

R & D MARINE HEAVY DUTY CIRCULAR SHEAR MOUNTING

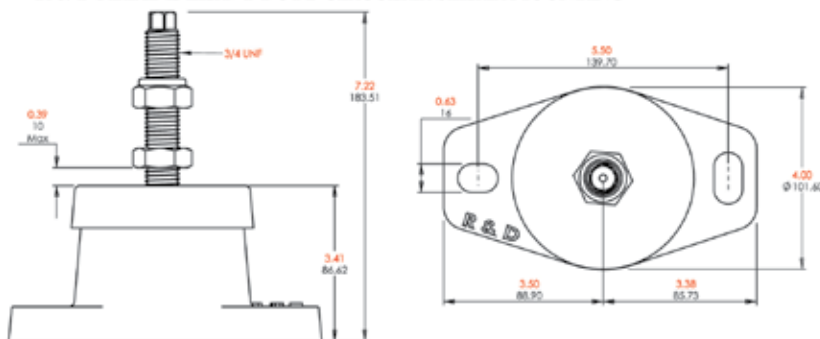

This mounting is designed to give excellent vibration isolation and is fitted with an oil shield to protect the rubber

3/4" Stud		
Part No	Capacity per mount	
	kg	lbs
800-015	228-546	500-1200
800-016	296-682	650-1500
800-017	400-910	880-2000

Mount Pre-loaded 3mm 0.12 inch
Deflection 3-6.4mm 0.012-0.25 inch
Height adjusting nut thickness 16mm 0.63 inch

R & D MARINE HEAVY DUTY CIRCULAR SHEAR MOUNTING



This mounting is designed to give excellent vibration isolation and is fitted with an oil shield to protect the rubber

1" Stud		
Part No	Capacity per mount	
	kg	lbs
800-055	228-546	500-1201
800-056	296-682	650-1501
800-057	400-910	880-2001

Mount Pre-loaded 3mm 0.12 inch
Deflection 3-6.4mm 0.012-0.25 inch
Height adjusting double nut and washer thickness 31.75mm 1.25 inch

Units of measurement: Black Millimetres Red Inches

Double Acting Mounting

R & D MARINE DOUBLE ACTING SHEAR LOADED MOUNTING

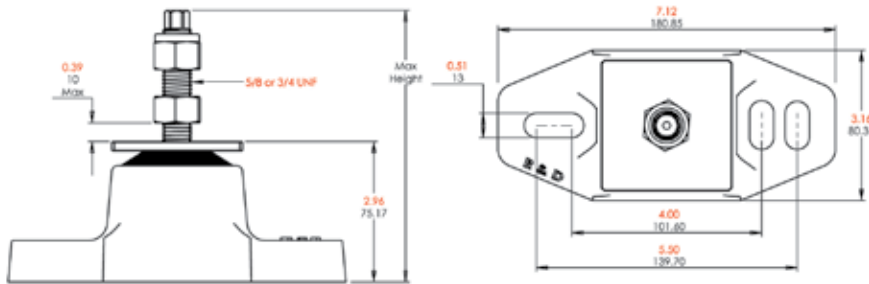

The Double Acting Shear Mount is a unique mounting incorporating 2 rubber elements which are pre-loaded against each other, giving excellent isolation together with good control on problem installations

5/8" Stud		3/4" Stud	
Part No	Capacity per mount kg lbs	Part No	Capacity per mount kg lbs
800-032	46-190 100-420	800-042	73-305 160-671
800-034	73-305 160-670		
Mount Pre-loaded 4.8mm 0.19 inch			
Deflection 4.8-7.6mm 0.19-0.30 inch			
Height adjusting			
nut thickness:		14mm 0.55 inch	11mm 0.43 inch
Maximum height		153mm 6.0 inch	153mm 6.0 inch

R&D Marine Engine Mountings

How To Select (details required)

1. Engine type and number of cylinders.
2. Type of gearbox and reduction ratio.
3. Weight of engine and gearbox combined by weighing or manufacturers literature.
4. Is the flywheel in conventional place between the engine and gearbox?
5. Position of the engine mounting points.
6. Find the center of gravity by balancing on a roller (if possible)

$$\text{Weight on each front mount} = \frac{W \times b}{2 \times (a+b)}$$

$$\text{Weight on each Rear Mount} = \frac{W \times a}{2 \times (a+b)}$$

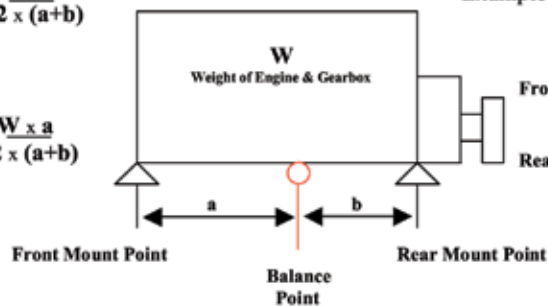

Example: Total weight of engine and gearbox = 1200 lbs
Distance a (balance point to front mount) = 17 inches
Distance b (balance point to rear mount) = 14 inches

$$\text{Front mount} = \frac{1200 \times 14}{2 \times (17 + 14)} = 270 \text{ lbs per front mount}$$

$$\text{Rear Mount} = \frac{1200 \times 17}{2 \times (17 + 14)} = 329 \text{ lbs per rear mount}$$

7. If the center of gravity cannot be found, assume weight distribution of 60% on rear mounts, with 40% on front mounts (if rear mount is in line with flywheel).

Type of Engine	Recommended Mounting Type				
	Double Acting	Small Compression	Compression	Small Shear	Medium & Large Shear
2 & 3 Cylinder Long Stroke	800-032, 034, 042	800-036	800-003, 4, 5		
1, 2 & 3 Cylinder Short Stroke High Speed		800-033, 036		800-038, 039 800-040, 041	800-010, 011
4 Cylinder		800-033, 036	800-003, 4, 5		SUPER MOUNTS See page 3
6 Cylinder and More			800-003, 4, 5		SUPER MOUNTS See Page 3 800-015, 016, 017

Installation Details

Maximum clearance between the underside of the height adjusting nut and top washer must not be more than 10mm. If more height is required use a spacer under the mounting casting. This applies to all mountings in the R&D Marine Range.

Units of measurement: Black = Millimeters Red = Inches

R&D by PYI Inc. offers a full line of drive train solutions such as



Split Couplings



Damper Plates



Flexible Shaft Couplings